



INDUSTRIAL WAREHOUSE FOR LEASE

1855 S Jackson St, Janesville, WI 53546

PROPERTY FEATURES

- Total Building SF: 80,033 SF
- Available Space: 40,000 SF
- Office Space: 1,600 SF
- Site Size: 6.86 AC
- Built in 1995
- Outdoor Storage
- 26 Foot Clear Heights
- 2 Drive In Doors (12x14)
- 63 Parking Stalls

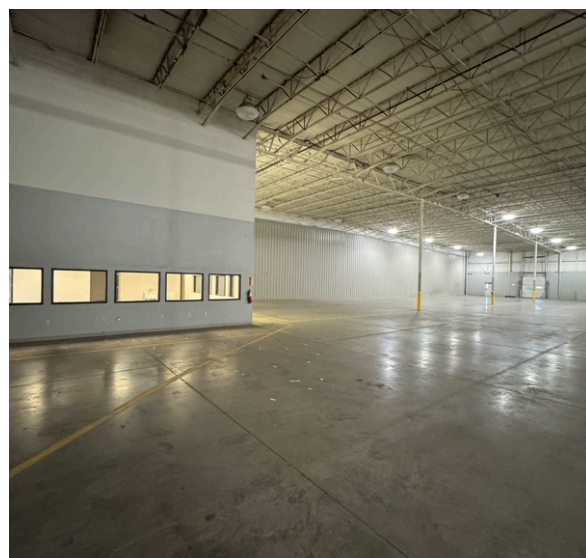

PROFESSIONALLY MANAGED BY:

Investors Associated, LLP
2310 Crossroads Drive, Suite 1200
Madison, WI 53718

FOR LEASING INFORMATION:

Ben Hurd
608.828.8888
bhurd@iallp.com

Travis Bouzek
608.390.3654
tbouzek@iallp.com

INDUSTRIAL WAREHOUSE FOR LEASE

1855 S Jackson St, Janesville, WI 53546

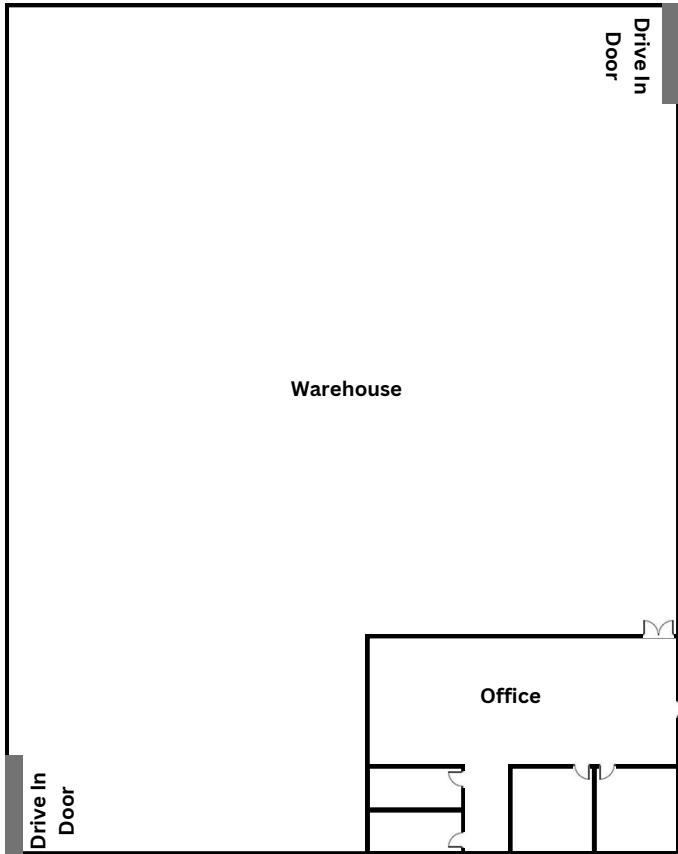

LOCATION HIGHLIGHTS

- Located 3 Miles off of Interstate 90 (5 Minutes)
- 33 Miles to Rockford (40 Minutes)
- 45 Miles to Dane County Regional Airport (45 Minutes)
- 73 Miles to Milwaukee Mitchell International Airport (1hr 12min)
- 93 Miles to Chicago O'Hare International Airport (1hr 25min)



PROFESSIONALLY MANAGED BY:

Investors Associated, LLP
2310 Crossroads Drive, Suite 1200
Madison, WI 53718

FOR LEASING INFORMATION:

Ben Hurd
608.828.8888
bhurd@iallp.com

Travis Bouzek
608.390.3654
tbouzek@iallp.com